

LEGEND

	EXISTING 2' CONTOUR		EXISTING FENCE
	EXISTING 10' CONTOUR		EXISTING DIRT OR GRAVEL ROAD
	PROPOSED 2' ASH CONTOUR		PROPOSED SLOPE DIVERSION DRAINAGE SWALE
	PROPOSED 10' ASH CONTOUR		PROPOSED CONSTRUCTION ENTRANCE PRIMARY TRUCK ROUTE
	PROPOSED CONSTRUCTION ENTRANCE ALTERNATE TRUCK ROUTE		

- NOTES:**
- SOURCE OF EXISTING CONTOURS FROM MAP TITLED "TOPOGRAPHIC SURVEY, PREPARED FOR CONNECTICUT RESOURCES RECOVERY AUTHORITY, HARTFORD LANDFILL, HARTFORD, CONNECTICUT", DATED: 1/17/07, SCALE: 1"=100', BY FUSS & O'NEILL.
 - ELEVATIONS ARE BASED UPON THE NATIONAL GEODETIC VERTICAL DATUM OF 1929 (NGVD 1929).
 - HORIZONTAL GRID IS BASED UPON THE CONNECTICUT GRID SYSTEM, NORTH AMERICAN DATUM OF 1927.
 - PROPOSED CONTOURS SHOWN REPRESENT ELEVATIONS OF THE ASH (SUBGRADE) SURFACE PRIOR TO PLACEMENT OF LANDFILL CAP SYSTEM.

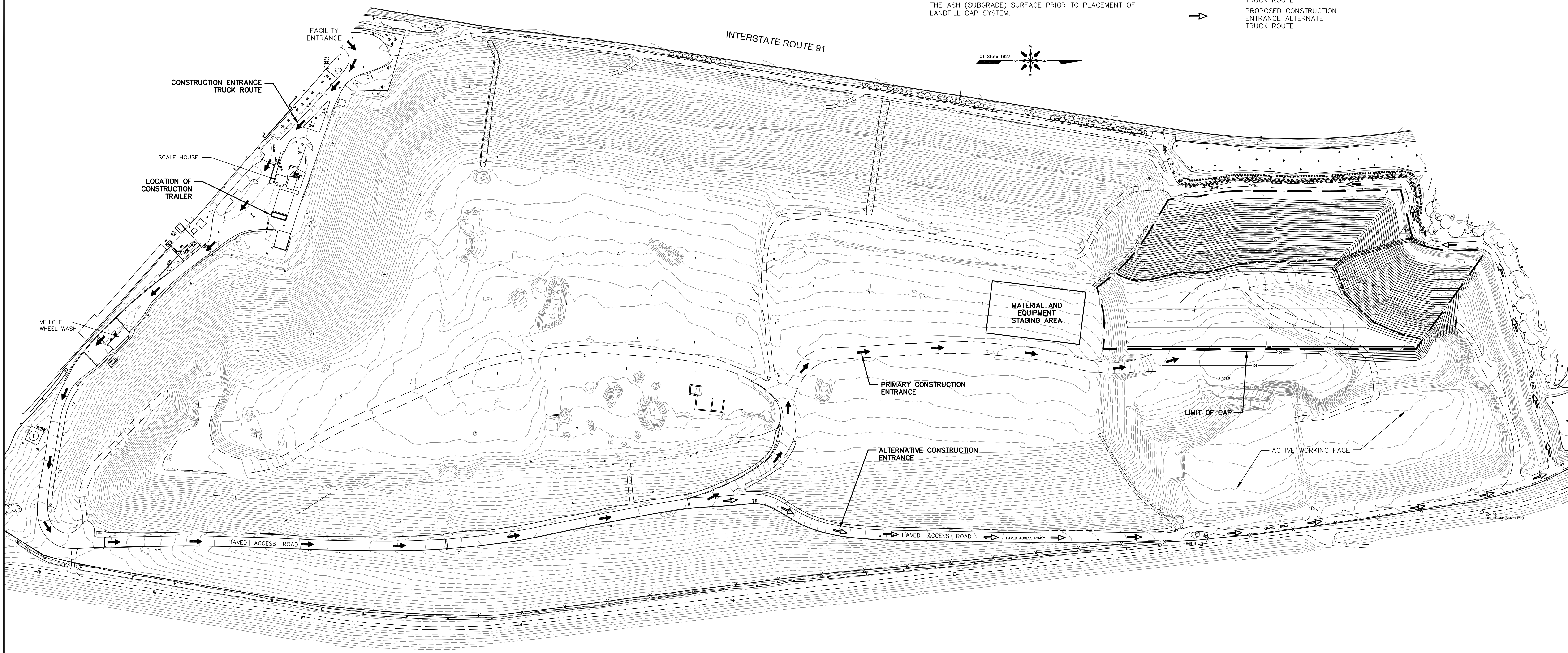

CONNECTICUT RIVER

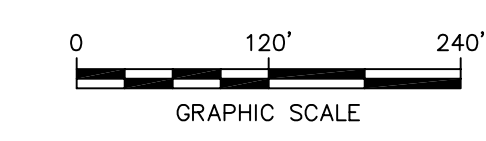

1	RELOCATED DOWNCHUTE	5/21/07	CNS
SYMBOL	REVISIONS	DATE	APPROVAL
<p>21 Griffin Road North Windsor, CT 06095 (860) 298-9692</p>		<p>CONNECTICUT RESOURCES RECOVERY AUTHORITY HARTFORD LANDFILL</p>	
<p>CARL N. STOPPER PROFESSIONAL ENGINEER CT PE # 13255</p>		<p>HARTFORD LANDFILL PHASE I ASH AREA PARTIAL CLOSURE SITE ACCESS PLAN</p>	
DESIGN:	MNB/MAP	05/01/07	SHEET 2
DRAWN:	KDH	05/01/07	SCALE: 1"=50'
CHECKED:	CNS	05/01/07	A-1
DATE:			