

P:\Disciplines\Architectural\Sheet\A-103.dwg May 22, 2008 12:00 PM

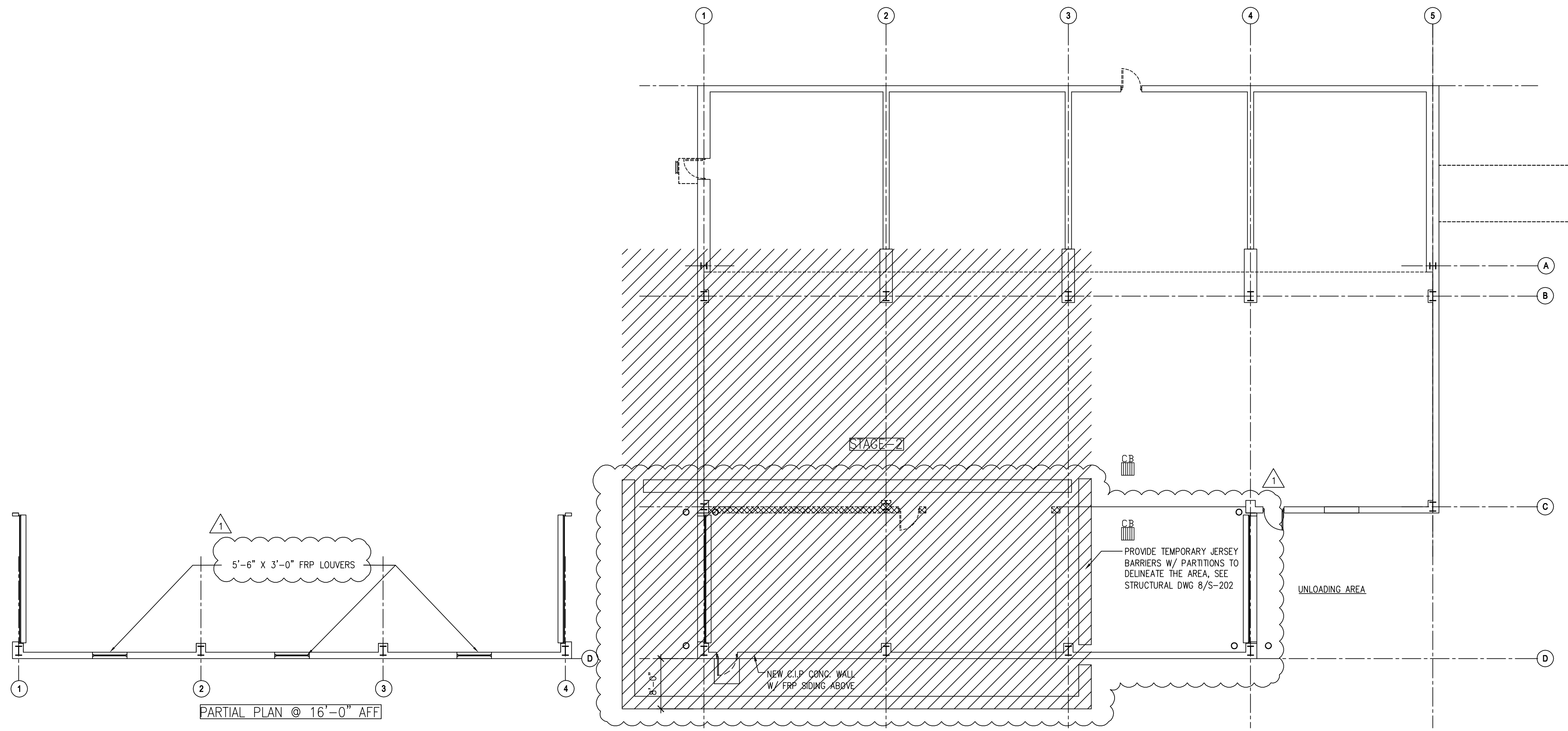

2 FLOOR PLAN (STAGE - 2)  
A-103 SCALE: 3/32" = 1'-0"

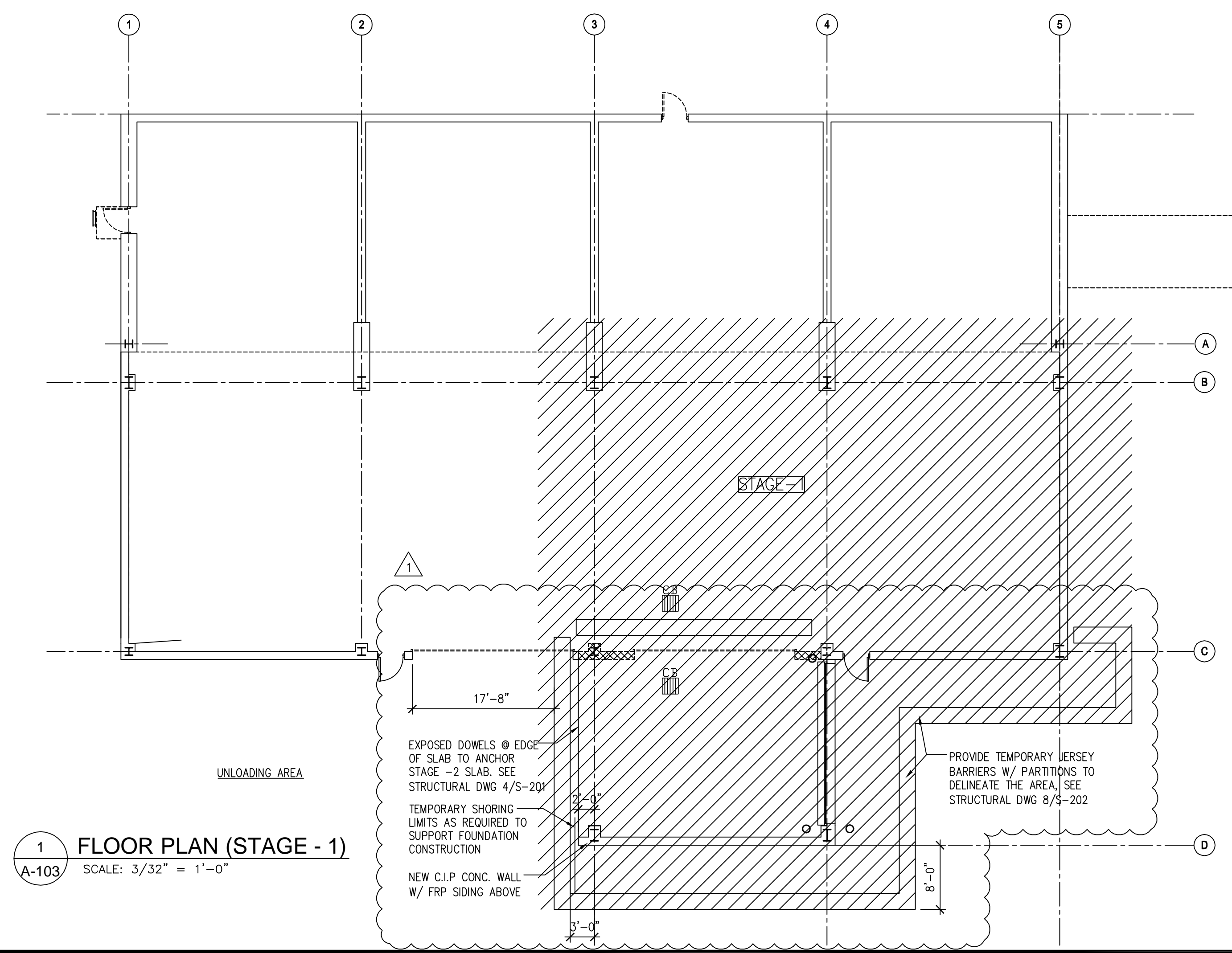

1 FLOOR PLAN (STAGE - 1)  
A-103 SCALE: 3/32" = 1'-0"

- SEQUENCE OF CONSTRUCTION NOTES:**
1. INSTALL TEMPORARY CONCRETE JERSEY BARRIER AS NOTED IN STAGE I.
  2. DEMOLISH PORTIONS OF EXISTING CONCRETE PUSH WALLS WHILE MAINTAINING CONCRETE PIERS AND EXISTING METAL BUILDING ROOF, WALLS AND FRAMING.
  3. CONSTRUCT NEW CAST-IN-PLACE CONCRETE PUSH WALLS, PIERS, FOUNDATIONS AND SLAB AS INDICATED IN STAGE I.
  4. DEMOLISH EXISTING METAL BUILDING INCLUDING BUT NOT LIMITED TO ROOF, WALLS, FRAMING, EXISTING CONCRETE PIERS, REMAINING EXISTING CONCRETE PUSH WALL IN STAGE I. NOTE - DEMOLISH OF EXISTING METAL BUILDING NOT TO BE PERFORMED UNTIL NEW FRAMING STRUCTURE ON SITE.
  5. TEMPORARY SHORE, BRACE AND/OR SUPPORT EXISTING ROOF AND WALL AT EXISTING PRE-ENGINEERED BUILDING TO REMAIN FOR STAGE II CONSTRUCTION.
  6. INSTALL NEW PRE-ENGINEERED BUILDING AND FRAMES ALONG COLUMN LINES 3, 5 AND BETWEEN COLUMN LINES A & D (STAGE I CONSTRUCTION).
  7. REMOVE TEMPORARY CONCRETE JERSEY BARRIERS AND RESET TEMPORARY JERSEY BARRIERS FOR STAGE II.
  8. DEMOLISH PORTIONS OF EXISTING CONCRETE PUSH WALL WHILE MAINTAINING EXISTING CONCRETE PIERS AND EXISTING METAL BUILDING, ROOF, WALLS AND FRAMING.
  9. CONSTRUCT NEW CAST-IN-PLACE CONCRETE PUSH WALLS, PIERS, FOUNDATIONS AND SLAB AS INDICATED IN STAGE II.
  10. DEMOLISH REMAINING EXISTING BUILDING INCLUDING BUT NOT LIMITED TO ROOF, WALLS, FRAMES, EXISTING CONCRETE PIERS AND REMAINING EXISTING CONCRETE PUSH WALLS IN STAGE II. NOTE - DEMOLISH OF EXISTING METAL BUILDING NOT TO BE PERFORMED UNTIL NEW FRAMING STRUCTURE ON SITE.
  11. INSTALL NEW PRE-ENGINEERED BUILDING AND FRAMES ALONG COLUMN LINES 1, 2 AND UP TO 3, BETWEEN COLUMN LINES A & D.
  12. REMOVE TEMPORARY CONCRETE JERSEY BARRIERS FROM STAGE II CONSTRUCTION AND FROM SITE.
  13. SEQUENCE OF CONSTRUCTION MAY BE VARIED WITH PERMISSION OF THE ENGINEER AND/OR OWNER.
  14. DEMOLISHING OF EXISTING METAL BUILDING AND FRAMES AS WELL AS INSTALLATION OF NEW FRAMES, PURLINS AND ROOF DECK MUST BE PERFORMED DURING OFF HOURS OF OWNER'S HAULING OPERATIONS.

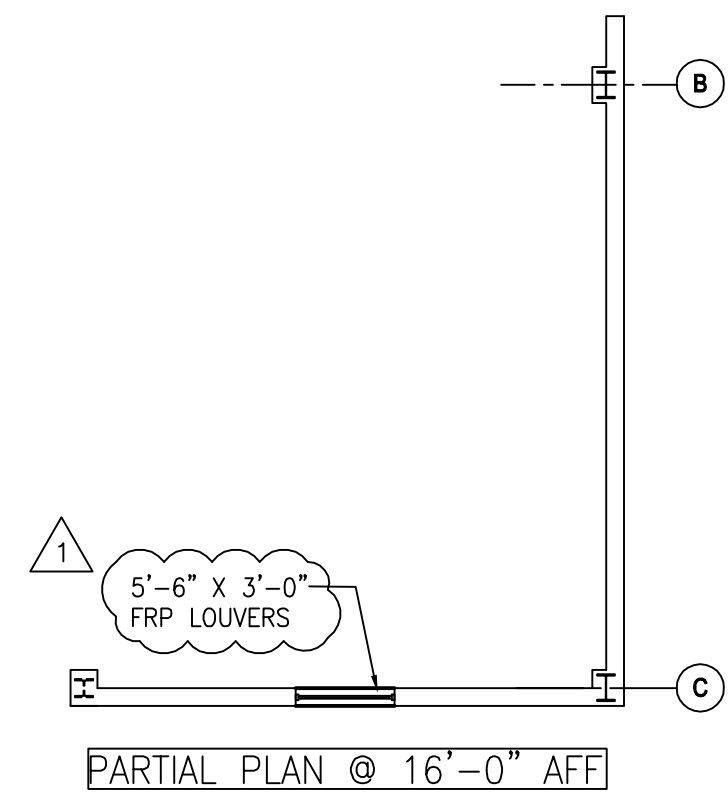

**CONNECTICUT RESOURCES RECOVERY AUTHORITY**  
TEL. NO. (860)-757-7700  
FAX. NO. (860)-757-7743

A&E FIRM  
**URS**  
URS CORPORATION AES  
500 ENTERPRISE DRIVE  
ROCKY HILL, CT. 06067  
1-(860)-529-8882

A&E SEAL

THE INFORMATION CONTAINED IN THIS SET OF DOCUMENTS IS PROPRIETARY BY NATURE. ANY USE, DISCLOSURE OTHER THAN THAT WHICH RELATES TO CONNECTICUT RESOURCES RECOVERY AUTHORITY IS STRICTLY PROHIBITED.

**REVISIONS**

NUMBER	DATE	REMARKS
1	05/23/08	PLAN MODIFICATIONS SEQ. OF CONST. NOTES

**MID-CONNECTICUT PROJECT  
POWER BLOCK FACILITY  
ASH LOADOUT BUILDING  
& SITE MODIFICATIONS**  
RESERVE ROAD  
HARTFORD, CT.

PROJECT NO: 36937668  
DRAWN BY: SM  
CHECKED BY: HSP  
DATE: 05/14/08  
CADD FILE: AS NOTED

**STAGING PLAN**

**A-103**