

- NOTES:**
- SOURCE OF EXISTING CONTOURS FROM MAP TITLED "TOPOGRAPHIC SURVEY, PREPARED FOR CONNECTICUT RESOURCES RECOVERY AUTHORITY, HARTFORD LANDFILL, HARTFORD, CONNECTICUT", DATED: 1/17/07, SCALE: 1"=100', BY FUSS & O'NEILL AND MAP TITLED "RECORD DRAWING OF THE PHASE I ASH AREA PARTIAL CLOSURE FOR THE CONNECTICUT RESOURCES RECOVERY AUTHORITY AT THE HARTFORD LANDFILL" DRAWING NO. R-1, SCALE: 1"=40', DATED: 10/3/08, BY E.T.&L. CORP..
  - ELEVATIONS ARE BASED UPON THE NATIONAL GEODETIC VERTICAL DATUM OF 1929 (NGVD 1929).
  - HORIZONTAL GRID IS BASED UPON THE CONNECTICUT GRID SYSTEM, NORTH AMERICAN DATUM OF 1927.
  - THE CONTOURS SHOWN IN THE WESTERN AND NORTHWESTERN PORTION OF THE ASH AREA REPRESENT THE LANDFILL CAP SYSTEM FINISHED GRADE ELEVATIONS. PROPOSED CONTOURS SHOWN REPRESENT ELEVATIONS OF THE ASH (SUBGRADE) SURFACE PRIOR TO PLACEMENT OF LANDFILL CAP SYSTEM.
  - EXISTING CONTOURS IN CELLS #1 & #3 ARE NOT PROVIDED INTENTIONALLY. THE CONTRACTOR SHALL PERFORM A TOPOGRAPHIC SURVEY OF THIS AREA PRIOR TO COMMENCING WITH CONSTRUCTION.
  - CONTRACTOR SHALL BE PREPARED TO USE ANY OF THE STAGING AREAS INDICATED.

LEGEND			
-----	EXISTING 2' CONTOUR	-----	PROPOSED 2' ASH CONTOUR
-----20-----	EXISTING 10' CONTOUR	-----20-----	PROPOSED 10' ASH CONTOUR
-X-X-	EXISTING FENCE	----->-----	PROPOSED SLOPE DIVERSION DRAINAGE SWALE
-----	EXISTING DIRT OR GRAVEL ROAD	-----	LIMIT OF PHASE I LINED ASH AREA
➔	PROPOSED CONSTRUCTION ENTRANCE PRIMARY TRUCK ROUTE		
➔	PROPOSED CONSTRUCTION ENTRANCE ALTERNATE TRUCK ROUTE		

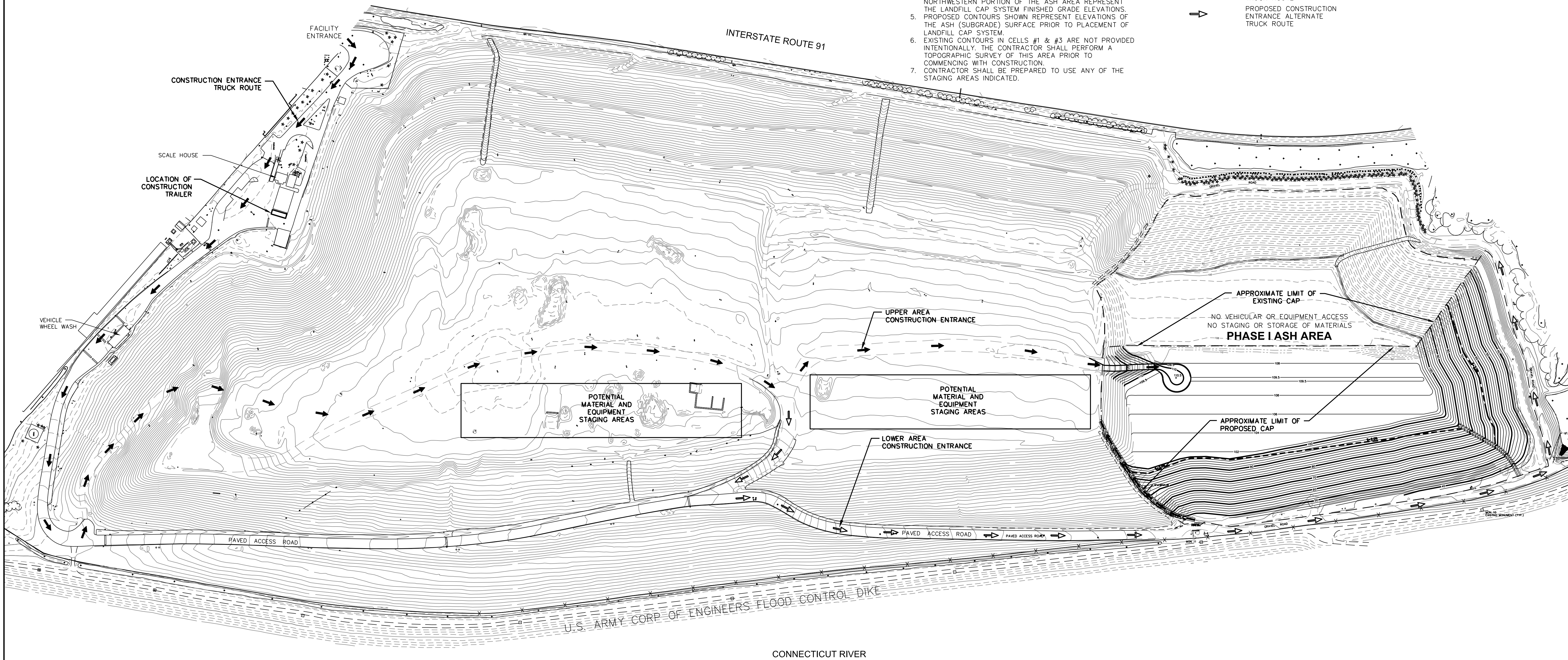

NO.	REVISIONS	DATE	APPROVAL

DATE: _____	<b>CONNECTICUT RESOURCES RECOVERY AUTHORITY</b> <b>HARTFORD LANDFILL</b> <b>HARTFORD, CONNECTICUT</b>	 21 Griffin Road North Windsor, CT 06095 (860) 298-9692
CARL N. STOPPER PROFESSIONAL ENGINEER CT PE # 13255		
<b>HARTFORD LANDFILL PHASE I ASH AREA</b> <b>FINAL CLOSURE</b>		DESIGN: MAB 03/02/09 DRAWN: KDH 03/02/09 CHECKED: CNS 03/02/09 SCALE: 1"=120' PROJECT: 153306-000260-000006 DRAWING
<b>SITE ACCESS PLAN</b>		<b>A-1</b>

